



Cartridge filter housing type 106

Possibility to use both single and double open filter cartridges. The CFH housing fitted with V-Clamp closures performs very well in a wide range of applications in the industrial fluid filtration process.

Type 106 can be used with the entire range of 3A filter cartridges and industry standard cartridges from 0.25 to 500 µm with nominal lengths of 10", 20" and 30".

Key Product Features:

- Construction 100% made of AISI 316L.
- V-Clamp type quick release closure.
- With a central inner rod and two knife seals, it is possible to use double open cartridges of 9.75" or 10"; 20"; 30".
- Adapted for SOE single opened cartridges in code 222 (double O-Ring)
- Housing according to pressure directive PED 2014/68/EC art.4 paragraph 3
- Housing surface mechanically polished

Technical data

Medium	CFH		
	10"	20"	30"
Group 1 liquid	10	10	10
Group 2 liquid	10	10	10

Max temperature 100 °C

Gaskets : EPDM; VITON; PTFE; Silicon.

CFH enclosure dimensions

Length	Dimension [mm]		Connection size			Volume [liter]
	A	B	Input/Output	Venting	Drain	
10	375	118	1" BSP	1/4" BSP	1/4" BSP	1,82
20	630	118				3,30
30	885	118				4,73

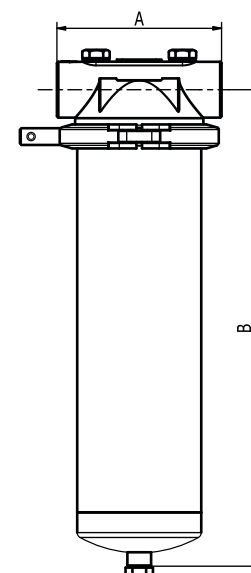

Single opened



Double opened